

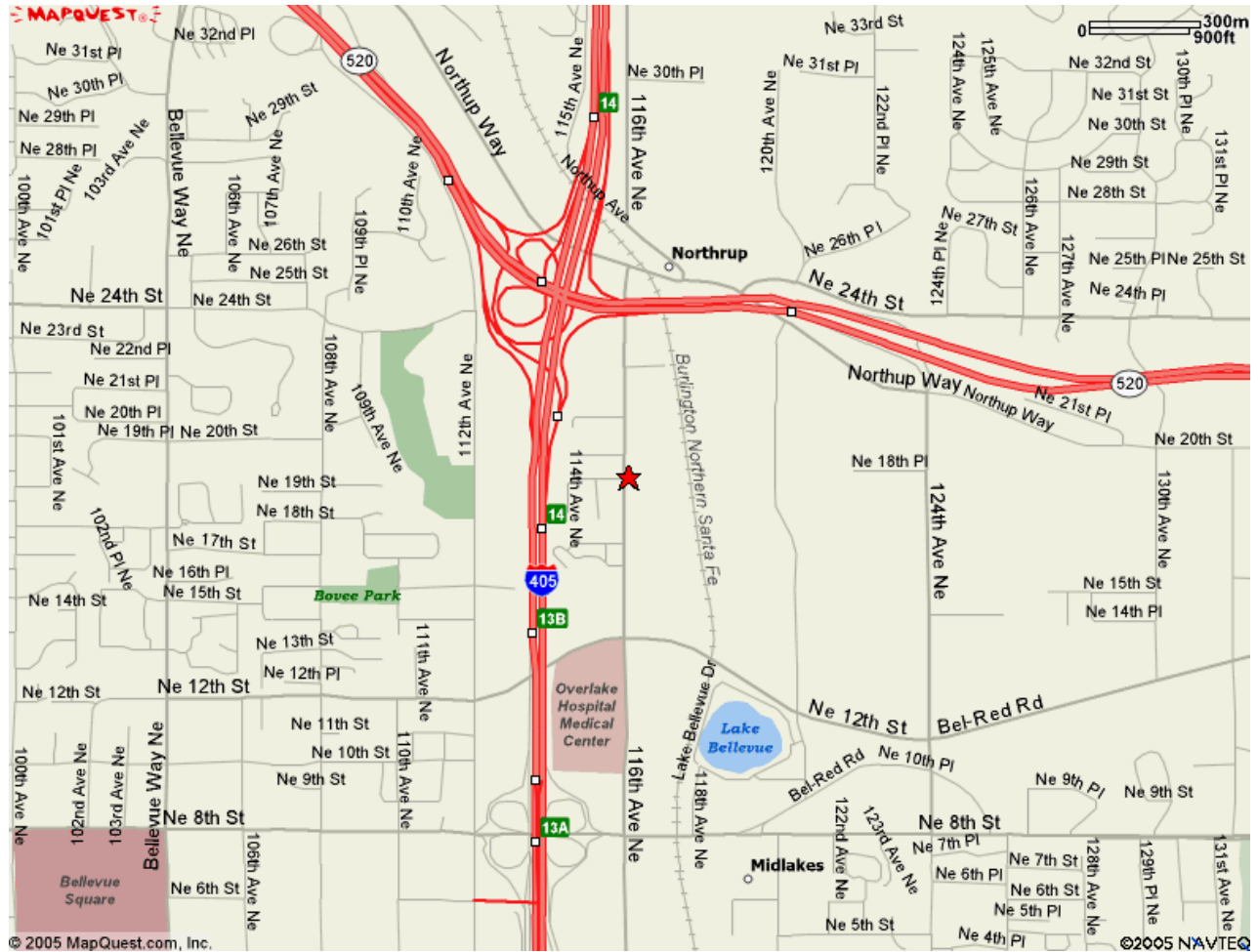

## Directions to Holistique Medical Center

### Address

1899 116<sup>th</sup> Ave NE.  
Bellevue WA 98004  
(425) 451-0404





## Directions to Holistique Medical Center

### **From south, heading north on I-405**

- Take exit number 12, 116th Ave./SE 8th St.
- Stay to the left of the exit, and take 116th Ave ramp
- At the end of the ramp, turn left into 116th Ave
- Follow 116th Ave for about 1.5 miles; go through NE 12th/Bell-Red Rd. light
- Turn left into NE 19th Street
- The Medical Center is located on your left

### **From North, heading south on I-405**

- Take exit number 13, NE 8th St., heading east (towards Hospital sign)
- Follow NE 8th St. for about .5 a mile
- Take a left on 116th Ave NE
- Follow 116th Ave for about 1 mile; go through NE 12th/Bell-Red Rd. light
- Turn left into NE 19th Street
- The Medical Center is located on your left

### **From I-90 (Seattle/Issaquah)**

- Head towards I-405
- Take I-405 North exit.
- Take exit number 12, 116th Ave./SE 8th St.
- Stay to the left of the exit, and take 116th Ave ramp
- At the end of the ramp, turn left into 116th Ave
- Follow 116th Ave for about 1.5 miles; go through NE 12th/Bell-Red Rd. light
- Turn left into NE 19th Street
- The Medical Center is located on your left